

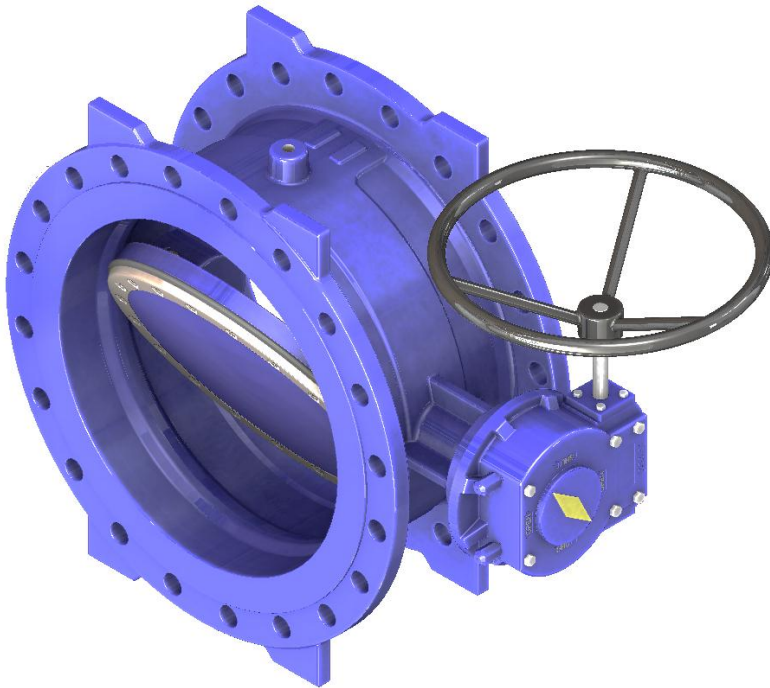

BUTTERFLY VALVES DOUBLE OFFSET KENNEDY SERIES 614 To EN/ISO Standards

Kennedy valves with its unique features have been used in water and fire protection industry since 1877. Our 61 Series butterfly valves conforms to EN / ISO standards and has been designed to maintain the high quality and integrity of existing designs but incorporates many superior features. The double offset sealing technology with the soft sealing element on the disc to provide high sealing Performance and reliability. Series 61 butterfly valves are made in cast ductile iron body with double flanged design and integral seats and suitable for bidirectional service. Valves are suitable for water and neutral liquids to a maximum temperature of 70°C.



General Specifications

614 : Double Offset Butterfly Valves Flanged
Sizes : DN 200 - DN 1200
Working Pressure : 16 Bar / 10 Bar

Design

EN 593, EN 1074-1&2 and **IS 13095**
Face To Face EN 558 / ISO 5752 Series 14

Flanges

EN 1092-2 - PN16 / PN10

Operator

Worm Gear with hand wheel, IP67
ISO 5211 Mounting flange standards
Open and close position indicator

Test Pressure

Pressure testing to EN 1074-1&2 and EN 12266-1&2
Seat Test : 1.1 x PN (18 Bar)
Body Test : 1.5 x PN (24 Bar)

Coating

Fusion bonded non-toxic epoxy coating NSF 61

Options

Replaceable SS 316 seats, Shaft in Duplex SS
External shaft locking mechanism
Underground gear operators
Various material combinations
PN10 or ANSI 150 drilling
Electric actuators
Head stock and extension stems

EPDM Rubber available with NSF61 approval suitable for potable water

DIMENSIONS AND PART LIST – Butterfly Valve Series 614

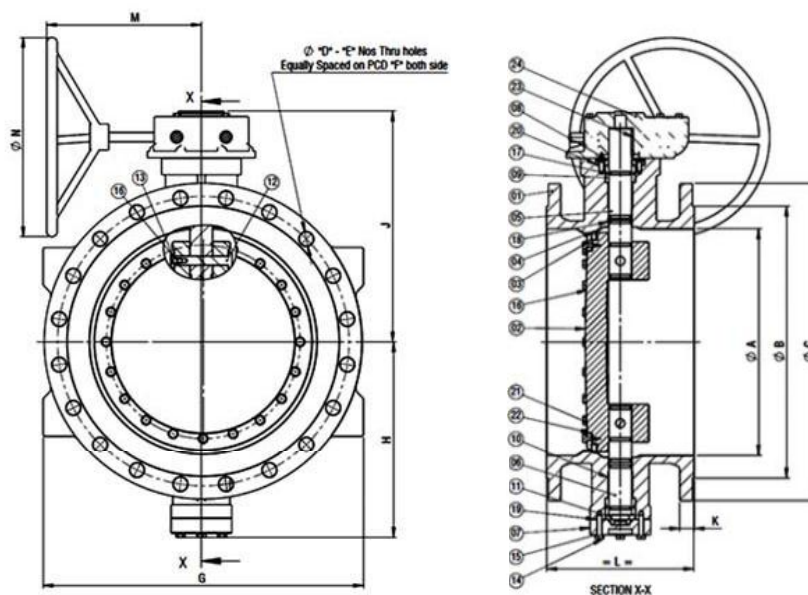

COMPONENTS

| Item No. | Item Description | Material | Item No. | Item Description | Material |
|----------|--------------------|------------------------------------|----------|-------------------------|--------------|
| 1 | Body | Ductile Iron EN 1563 EN JS 1050 | 13 | Dowel Pin Washer | SS 316/EPDM |
| 2 | Disc | Ductile Iron EN 1563 EN JS 1050 | 14 | Hex. Screw | ASTM A193B8M |
| 3 | Seat Retainer Ring | SS 316 | 15 | Sealing Washer | SS 316/EPDM |
| 4 | Seat Ring | EPDM | 16 | CSK Screw (Dowel Pin) | ASTM A193B8M |
| 5 | Upper Shaft | SS 316 | 17 | O' Ring (Bush) | EPDM |
| 6 | Lower Shaft | SS 316 | 18 | O' Ring (Stem) | EPDM |
| 7 | Bottom Flange | CF8M | 19 | O' Ring (Bottom Flange) | EPDM |
| 8 | Gland Plate | SS 316 | 20 | Gland Gasket | EPDM |
| 9 | Bush | PH.BRONZE | 21 | Hex. Screw | ASTM A193B8M |
| 10 | Plain Bearing | PTFE/SS304 | 22 | O' Ring (Retainer Ring) | EPDM |
| 11 | Thurst Washer | PH.BRONZE | 23 | Key | SS 410 |
| 12 | Dowel Pin | SS 316 | 24 | Gear Box | |

(Materials to trim 601)

DIMENSIONS (mm) for PN 16

| SIZE | L | ØA | ØB | ØC | Flange | | | ØG | H | J | K | M | ØN | Wt Kgs |
|--------|-----|-----|-----|-----|--------|-------|--------|-----|-----|-----|----|-----|-----|--------|
| | | | | | ØD | E Nos | ØF PCD | | | | | | | |
| DN 200 | 230 | 200 | 266 | 340 | 23 | 12 | 295 | 346 | 210 | 288 | 20 | 257 | 200 | 50 |
| DN 250 | 250 | 250 | 319 | 400 | 28 | 12 | 355 | 406 | 235 | 313 | 22 | 257 | 200 | 65 |
| DN 300 | 270 | 300 | 370 | 455 | 28 | 12 | 410 | 460 | 274 | 351 | 25 | 275 | 250 | 97 |
| DN 350 | 290 | 350 | 429 | 520 | 28 | 16 | 470 | 530 | 318 | 397 | 27 | 275 | 250 | 131 |
| DN 400 | 310 | 400 | 480 | 580 | 31 | 16 | 525 | 592 | 333 | 412 | 28 | 280 | 300 | 162 |
| DN 500 | 350 | 500 | 609 | 715 | 34 | 20 | 650 | 722 | 422 | 489 | 32 | 336 | 400 | 278 |
| DN 600 | 390 | 600 | 720 | 840 | 37 | 20 | 770 | 846 | 521 | 613 | 38 | 397 | 500 | 442 |

Kennedy Valve and MSPL are divisions of McWane Inc. USA
The specifications and material grades shown are subject to revision without notice based on our product improvement programme